

# AMERECON

## Initial-Pinch Plate Bending Rolls with Power Rear Roll Adjustment Model SRS

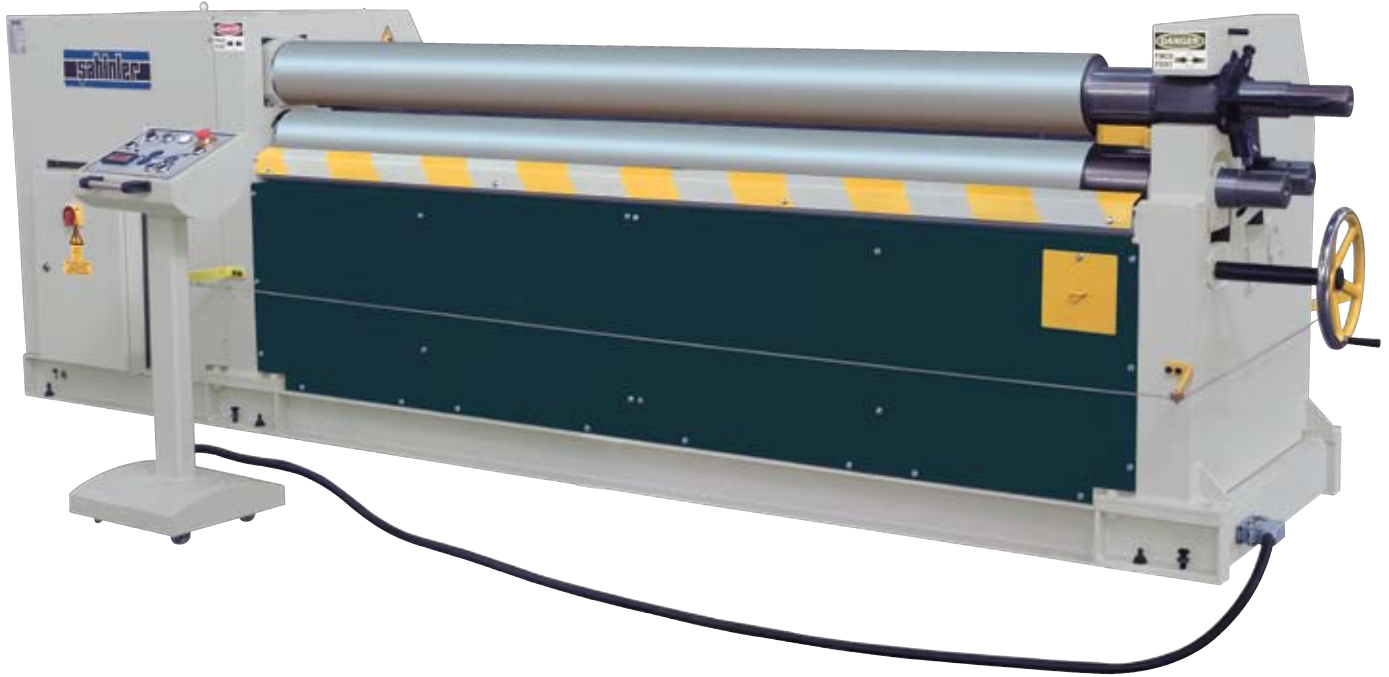

Standard manual drop end



Extended shafts for optional profile bending & section bending rolls

### TECHNICAL SPECIFICATIONS AND STANDARD FEATURES

- Two rolls are powered by a belt driven worm type gearbox, gear and chain system.
- SAE 1050 quality certified steel rolls with high tensile strength
- Steel welded main frames
- Power adjustment of rear roll
- Mobile control panel
- Cone bending attachment
- Central lubrication
- Top roll support system
- Precision bending with brake motor
- Mechanical manual open end
- Extended roll shafts for angle & shape bending
- Built according to EC safety directives (CE mark)
- User's manuals

### OPTIONAL EQUIPMENT

- Digital read-out for position of the rear roll
- Induction hardened rolls
- Angle & shape bending rolls
- Motorized bottom roll

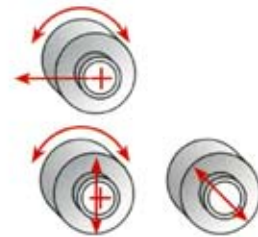

Control panel with optional digital read-out

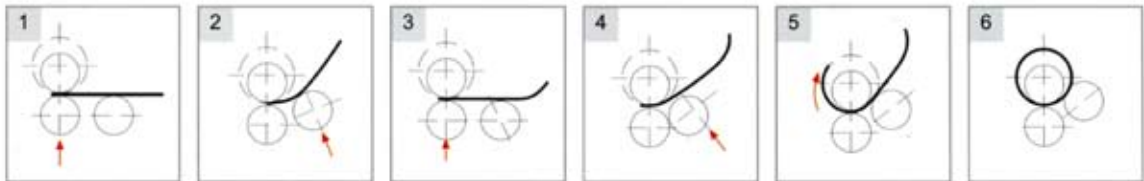

COLE-TUVE, INC. P.O. Box 233, White Marsh, MD 21162

<b><u>MODEL</u></b>	<b><u>CAPACITY</u> (mild steel)</b>	<b><u>DIAMETER</u> of the rolls</b>
<b>SRS-3-130</b>	<b>3' x 1/4"</b>	<b>5.12"</b>
<b>SRS-3-150</b>	<b>3' x 5/16"</b>	<b>5.91"</b>
<b>SRS-3-190</b>	<b>3' x 3/8"</b>	<b>7.48"</b>
<b>SRS-4-130</b>	<b>4' x 1/4"</b>	<b>5.12"</b>
<b>SRS-4-150</b>	<b>4' x 5/16"</b>	<b>5.91"</b>
<b>SRS-4-190</b>	<b>4' x 3/8"</b>	<b>7.48"</b>
<b>SRS-5-130</b>	<b>5' x 1/4"</b>	<b>5.12"</b>
<b>SRS-5-170</b>	<b>5' x 5/16"</b>	<b>6.69"</b>
<b>SRS-6-130</b>	<b>6' x 10 ga.</b>	<b>5.12"</b>
<b>SRS-6-150</b>	<b>6' x 3/16"</b>	<b>5.91"</b>
<b>SRS-6-170</b>	<b>6' x 1/4"</b>	<b>6.69"</b>
<b>SRS-8-150</b>	<b>8' x 10 ga.</b>	<b>5.91"</b>
<b>SRS-8-180</b>	<b>8' x 3/16"</b>	<b>7.09"</b>
<b>SRS-8-190</b>	<b>8' x 1/4"</b>	<b>7.48"</b>
<b>SRS-10-160</b>	<b>10' x 1/8"</b>	<b>6.30"</b>
<b>SRS-10-190</b>	<b>10' x 10 ga.</b>	<b>7.48"</b>
<b>SRS-10-200</b>	<b>10' x 3/16"</b>	<b>7.87"</b>
<b>SRS-10-220</b>	<b>10' x 1/4"</b>	<b>8.66"</b>

*Other capacities available on request.*